

PLYWOOD

Plywood is a wood-based product that is formed by gluing veneers, where the fibers of adjacent layers are perpendicular. Plywood is usually made of pine, spruce, beech, alder and birch. Due to the type of glue used in its production, plywood stands out as durable and waterproof (water resistance refers to the adhesive instead of the entire timber as a product, which is not resistant to water). Plywood can be easily modeled which allows for the production of shapes useful for example in furniture production. As a result, plywood is commonly used in the manufacture of home and office furniture, as well as in construction, packaging and shipbuilding industries.

STANDARDS:

PN-EN 635-2, PN-EN 323, PN-EN 310, PN-EN 318,
PN-EN 13986, PN-EN 13501-1, PN-EN 322

THICKNESS:

3,0; 4,0; 5,0; 6,0; 8,0; 9,0; 10,0; 12,0; 15,0; 18,0;
21,0; 24,0; 27,0; 30,0 mm

STANDARD DIMENSIONS:

1525x1525, 1220x2440, 1250x2500 mm

AVAILABLE PLYWOOD GRADES:

B/BB, BB/BB BB/CP, BB/C, CP/CP, CP/C, C/C

CHARACTERISTICS OF PLYWOOD GRADES:

1. Class B (1) - uniform, free from discoloration, bright surfaces;
2. Class BB (2) - uniform, free-discolored surfaces, with an acceptable amount of full knots;
3. Class CP (3) - uniform, with full knots and acceptable minor cracks in the fog;
4. Class C (4) - uniform, ground or ground surfaces with open knots and defects.

TYPES OF PLYWOOD DUE TO WATER:

dry-durable, waterproof

- one of the most durable wood-based materials in the world,
- waterproof,
- high durability,
- equal properties along and across the sheet,
- dimensional stability,
- supplement to the structure of the wall: as foundations, frames, lintels, window and door lintels,
- very high quality and durability,
- due to the large surface area, the number of mounting joints is reduced.

Physico-mechanical properties of boards

Parameter:	Value:
Humidity	4-12% (PN-EN 322)
Thickness	550-800 kg/m ³ (PN-EN 323)
Flexural strength	30-100 MPa* (PN-EN 310)
Tensile strength	30-60 MPa* (PN-EN 310)
Compressive strength	25-50 MPa* (PN-EN 310)
Modulus of elasticity	3 500-10000 MPa* (PN-EN 310)
Dimensional changes depending on humidity change	to 0,5% (PN-EN 318)
Class reaction to fire	D-s2,d0 for thickness>9mm (PN-EN 13986 PN-EN 13501-1)

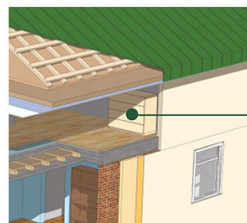

Plywood is often used
for furniture production.



Logistics information – packing method

No	Thickness [mm]	Width [mm]	Length [mm]	Pieces / pallet	m ² / pallet	pallet / semi-trailer	Pieces / semi-trailer	m ² / semi-trailer	m ³ / semi-trailer
1	3,0	1525	1525	130	302,33	32	4160	9674,60	29,02
2	4,0	1525	1525	100	232,56	32	3200	7442,00	29,76
3	5,0	1525	1525	80	186,05	32	2560	5953,60	29,76
4	6,0	1525	1525	65	151,16	32	2080	4837,30	29,02
5	8,0	1525	1525	50	116,28	32	1600	3721,00	29,76
6	9,0	1525	1525	45	104,65	32	1440	3348,90	30,14
7	10,0	1525	1525	40	93,02	32	1280	2976,80	29,76
8	12,0	1525	1525	33	76,74	32	1056	2455,86	29,47
9	15,0	1525	1525	27	62,79	32	864	2009,34	30,14
10	18,0	1525	1525	22	51,16	32	704	1637,24	29,47
11	21,0	1525	1525	19	44,18	32	608	1413,98	29,69
12	24,0	1525	1525	17	39,53	32	544	1265,14	30,36
13	27,0	1525	1525	15	34,88	32	480	1116,30	30,14
14	30,0	1525	1525	13	30,23	32	416	967,46	29,02



Search for certified FSC
products in our offer

